

***SENS*ALARM[®] PLUS**

Remote Sensor Kits

Installation Manual

Document No. 360-0127-01
(Revision D)

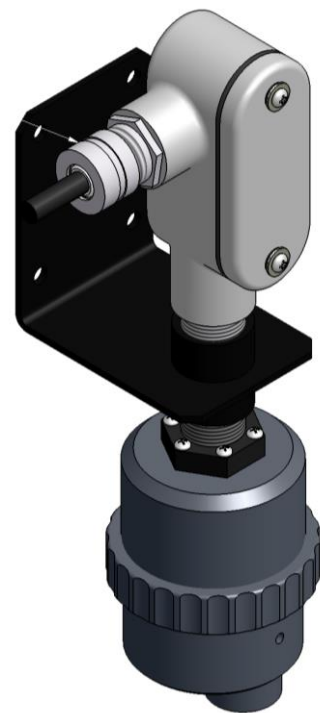

SENSIDYNE[®]

Sensidyne, LP
1000 112th Circle N, Suite 100
St. Petersburg, Florida 33716 USA
800-451-9444 • +1 727-530-3602 • +1 727-539-0550 [fax]
web: www.sensidyne.com • e-mail: info@sensidyne.com

WARNINGS PAGE

WARNINGS

READ AND UNDERSTAND ALL WARNINGS BEFORE USE

Read and understand ALL warnings before using this product. Failure to read, understand, and comply with ALL warnings could result in property damage, severe personal injury, or death.

Installation must be done in accordance with all local electrical codes. Follow standard grounding procedures when wiring the Remote Sensor Kit. All warnings and installation instructions should be read and understood as contained in the SensAlarm Plus Universal Gas Monitoring System User Manual (P/N 360-0126-01).

Sensor Interface Assembly must be mounted such that condensation and dust does not collect on the Sensor.

Read and understand ALL applicable federal, state, and local environmental health and safety laws and regulations, including OSHA. Ensure complete compliance with ALL applicable laws and regulations before and during use of this product.

The user/installer must understand the Hazardous Area Protection Concepts and Area Classifications applicable to their operation.

UNDER NO CIRCUMSTANCES should this product be used except by qualified, trained, technically competent personnel and not until the warnings, User Manual, labels, and other literature accompanying this product have been read and understood.

Failure to read and understand the User Manual may result in preventable severe personal injury or death.

DO NOT remove, cover, or alter any label or tag on this product, its accessories, or related products.

DO NOT operate this product should it malfunction or require repair. Operation of a malfunctioning product, or a product requiring repair may result in serious personal injury or death.

DO NOT attempt to repair or modify instrument, except as specified in the Operation & Service Manual. If repair is needed, contact the Sensidyne Service Dept. to arrange for a Returned Material Authorization (RMA) (See Section in the SensAlarm Plus Universal Gas User Manual (**P/N 360-0126-01**) for details).

The SensAlarm Plus Universal Gas Monitoring System is an ambient air monitoring device. Restricting the access of ambient air to the sensor may result in less than optimal monitoring performance.

NOTES:

1. The sensor may be oriented from horizontal down to vertical. The surface of the sensor must be protected from moisture (condensation) and dust.

• **821-0301-01 Remote Sensor Kit for use with SenAlarm Plus Models**

SensAlarm Plus Remote Sensor Kit (P/N 821-0301-01) contains the following items

(Note: References in brackets refer to letter/number references in Figure 1):

Ref No.	Sensidyne.P/N	DESCRIPTION
[A-2]	550-4003-01	Aluminum Condulet Nipple, ¾ NPT (Qty 1)
[A-3]	522-0002-02	Cover, Condulet (Qty = 1) (Shown Assembled)
[A-3]	522-0002-03	Gasket, Neoprene, (Qty = 1) (Shown Assembled)
[A-3]	522-0002-04	Junction Condulet with two 90° ¾ NPT openings
[A-4, A-6]	7017291	Watertight Cable Entry / Cable Strain Relief (Qty = 2)
(Not shown)	205-0081-01	Splice 2 pos (Qty = 4)
[A-7]	380-0021-01	Bracket Weld Assembly (Black Anodized) (Qty 1)

Cable Specification: 18AWG x 4 Conductor (Shielded) uH/ft < 0.2, pf/ft < 60, Max length 100ft/30m
Cable to be Customer Supplied. Belden 27326AS or equivalent.

Installation

Refer to Figure 1 and install the Remote Sensor Kit as follows:

- 1) Fasten the Bracket [A-7] to the desired location. Sensor Interface Assembly must be mounted such that condensation and dust does not collect on the Sensor. Thread the wires from the Sensor Interface Assembly [A-8] through the Bracket [A-7] and Nipple [A-2], tighten to secure.
(Note: If you are using tools to tighten the Sensor Interface Assembly make certain you use them ONLY on the Aluminum hex nut which came attached to the top of the Sensor Interface Assembly.)
- 2.) Thread the wires from the Sensor Interface Assembly [A-8] into the lower opening of the Junction Condulet [A-3]. Tighten the the Junction Condulet [A-3] to the Nipple [A-2]
(Note: If you are using tools to tighten the Sensor Interface Assembly make certain you use them ONLY on the Aluminum hex nut which came attached to the top of the Sensor Interface Assembly.)
- 3) Thread the customer-supplied remote cable [A-5] through the Watertight Strain Relief [A-6].and tighten to secure remote cable.
- 4) Wire the remote cable to the interface using 4 of the Splices provided.
Wire accordingly (R = Red, B = Black, O = Orange, Y = Yellow).
Install the Condulet Gasket and Cover.)
- 5) Route and secure the customer-supplied remote cable [A-5] to the SensAlarm Plus Location [A-1].
- 7) Thread the wires through the Watertight Strain Relief [A-4], and tighten to secure remote cable.
- 8) Wire the remote cable to the SensAlarm [A-1]. Wire accordingly (R = Red, B = Black, O = Orange, Y = Yellow). Connect the shield wire to the TB2 Pin 5 Barrier PCA in the SensAlarm Plus.

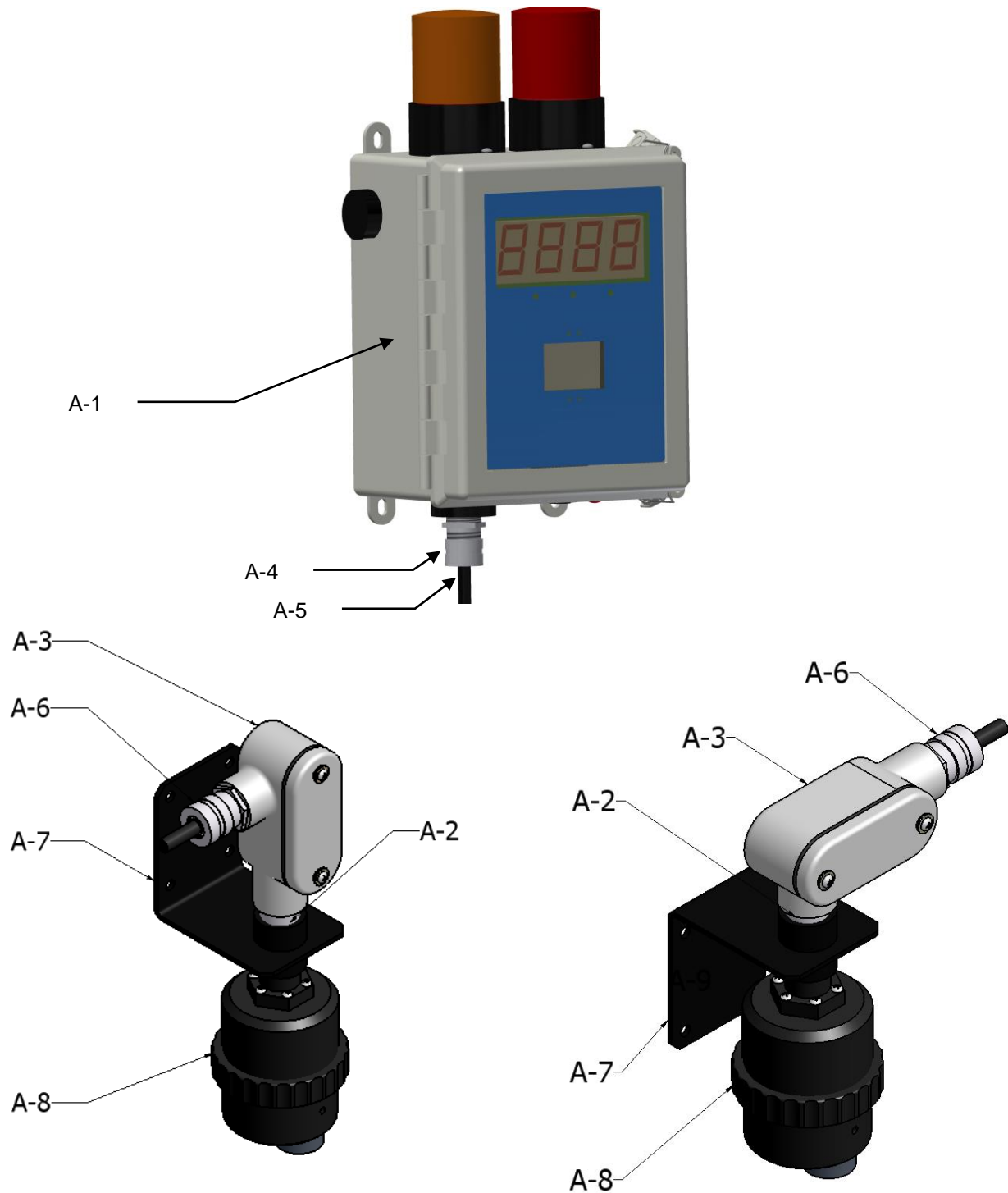

Floor Mount

Ceiling Mount

Invert Mounting Bracket A-7

Figure 1
Remote Sensor Kit Installation



Sensidyne, LP
1000 112th Circle N, Suite 100
St. Petersburg, Florida 33716 USA
800-451-9444 • +1 727-530-3602 • +1 727-539-0550 [fax]
web: www.sensidyne.com • e-mail: info@sensidyne.com